



Japan Super Rally series round 1

International Rally of TSUMAGOI



Feb. 2~5. 2017

Supplementary Regulations International - JSR round 1



rally & racing
AG.M.S.C
HOKKAIDO

Autoclub JAPAN
オートクラブ

M O S C O
MOTOR SPORTS COORDINATE

<http://www.n-mosco.com>

Index

1	Announcement.....	2
2	Organisation and Description.....	2-3
3	Programme.....	4
4	Entries.....	5-7
5	Insurance.....	8
6	Advertising and Identification.....	9
7	Tyres.....	9
8	Fuel.....	9
9	Reconnaissance.....	9-10
10	Administrative Checks.....	10
11	Scrutineering Venue and Schedule.....	10-11
12	Other Procedures.....	11-13
13	Identification of Officials.....	13
14	Prizes.....	13
15	Post event Scrutineering and Protest	14
16	Interpretation of the Regulations.....	14
Appendix 1	Itinerary	15-16
Appendix 2	Reconnaissance Schedule.....	17
Appendix 3	Names and Photographs of CROs.....	17
Appendix 4	HQs and the Service Park Locations.....	18
Appendix 5.1	HQs Layout.....	19
Appendix 5.2	Satellite HQ Layout.....	20
Appendix 6	Start Light Sequence	21
Appendix 7	Competition Numbers and Advertising.....	22
Appendix 8	Super Special Stage Procedure	23
Appendix 9	Flexi Service.....	23
Appendix 10	Stud Tyres.....	24

1 Announcement

1.1 General

The Rally of Tsumagoi will be running in compliance with the FIA International Sporting Code (and its appendices), the 2017 FIA Regional Rally Sporting Regulations, the National Regulations of Japan Automobile Federation (JAF) which comply with the FIA regulations, and these Supplementary Regulations.

Modifications, amendments and or changes to these Supplementary Regulations will be announced only by numbered and dated Bulletins (issued by the organiser or the stewards)

the 2017 FIA Regional Rally Sporting Regulations can be found at <http://www.fia.com/sport/regulations>

1.2 Road Surface

Snow, ice and/or frozen asphalt

1.3 Overall Special Stage Distance and Total Distance of the Itinerary

SS distance : 86.326km

Total distance : 410.754km

2 Organisation and Description

2.1 Event name, date and location

Status	: FIA INTERNATIONAL RALLY
Name	: RALLY of TSUMAGOI
Date	: 02 FEB (THU) – 05 FEB (SUN) 2017
Location	: Tsumagoi village, Gunma prefecture

2.2 Eligibility

FIA 2017 Japan Super Rally series round 1

JAF 2017 All Japan championship / East Japan championship / JMRC Kanto series

2.3 VISA numbers

FIA VISA NO : 2017-0001	issued on 24 NOV 2016
JAF VISA NO : 2017-0001	issued on 24 NOV 2016

2.4 Event operation

Name	: Japan Motorsports Association (JMA)
Address	: C/O CINQ LLC 5-5-21-202 Hutako, Takatsu, Kawasaki, Kanagawa, Japan TEL : +81-(0)44-850-5115 FAX : +81-(0)44-850-5116

2.5 Organiser

Name	: AG Members Club Hokkaido
Address	: Homei Building, Minami 4-9, Nangodori, Shiroishi-ku, Sapporo, Hokkaido, Japan TEL : +(0)11-864-2003 FAX : +(0)11-864-1182 E-mail : info@homei-gr.com URL : http://www.rally-hokkaido.com
Name	: Jyoshu Auto Club
Address	: 128-2, Kobayashicho Ota, Gunma Japan TEL : +(0)276-25-0114 FAX : +(0)276-25-6996 E-mail : info@kit-service.jp URL : http://www.n-mosco.com/jac/index.html

2.6 Organising Committee

Chairman: Ryuji MAKITA
 Deputy Chairman: Haruo TAKAKUWA
 Members: Takayuki KOSEKI Hiroshi SUZUKI
 Masaya YAMAGUCHI Mamoru NAMIKI

2.7 Stewards of the Meeting

Chairman: Mr. Peter MACNEALL
 Members of the Panel: Mr. Jirou NAKANO Mr. Takahisa OGUCHI

2.8 Senior Officials

Clerk of the Course: Ryuji MAKITA
 Deputy Clerk of the Course: Sadatoshi ANDO Tetsuya IKEDA
 Chief Route Officer: Shogo NAKATA
 Deputy Route Officer: Akio KOBAYASHI Etsuo SHINOHARA Keiji TAKANO
 Chief Timing officer: Naoki KUROSAKI
 Deputy Timing Officer: Masaya YAMAGUCHI Shin NAGAI
 Chief Scutineer: Mamoru NAMIKI
 Deputy Scrutineer: Toshiaki ORIHARA
 Chief Medical Officer: Hiroshi SUZUKI
 Deputy Medical Officer: Akira YONEZAWA
 Secretary General: Toshinori NISHII
 Secretary: Akira KAWADA Sumiko CHIYODA
 Spectator Safety Officer: Yoshiyuki SAIKUBO
 Media Relation Officer: Isao KONO
 Service Park Coordinator: Takuya SUGIMURA
 Chief Doctor: Hitoshi ATOMI
 Doctor: Hidetaka GOTO Taknoru KAMITANI
 Nurse: Eri MARUYAMA Sachiko OTAKE
 Emergency Medical Technician: Ken TAMURA
 Competitors Relation Officer: Naoto MARUYAMA Shunsaku KODERA

2.9 HQs address and contact details

Hotel Green Plaza, Main Building Restaurant 2F
 2277 Ohmaehosobara, Tsumagoi, Agatsuma, Gunma, Japan
 TEL: +81-(0)279-86-4111 (Hotel Green Plaza)
 The HQs telephone during the rally +81-(0)279-86-5662
 HQs open from 15:00 02 FEB(THU) till 21:00 05 FEB 2017

2.10 Rally of Tsumagoi Permanent Secretariat

M.O.S.C.O.

1514-1 Sarugakyoonsen, Minakami, Tonegun, Gunma, 379-1403 Japan

TEL: +81-(0)277-20-4633/ FAX: +81-(0)278-66-1000

E-mail: entry@n-mosco.com URL : <http://www.n-mosco.com>

3 Programme

Year	Dates	hours	Descriptions	Locations
2016	10 NOV (THU)		Issue of Supplementary Regulations	Permanent Secretariat / Website
	24 NOV (THU)	09:00	Entries open for Overseas Competitors	Permanent Secretariat
	08 DEC (THU)	09:00	Entries open for National Competitors	Permanent Secretariat
		09:00	Opening for Media Accreditation Application	Permanent Secretariat
	20 DEC (SUN)	21:00	Issue of Rally Guide 2	Permanent Secretariat / Website
	23 DEC (FRI)	19:00	Entry closes for Overseas Competitors	Permanent Secretariat
2017	10 JAN (TUE)	21:00	Entry closes for National Competitors	Permanent Secretariat
	19 JAN (THU)	19:00	Publication of Entry List	Permanent Secretariat / Website
		19:00	Closure of Media Accreditation	Permanent Secretariat
	24 JAN (SUN)	19:00	Issue of Road Books / Route Maps	Permanent Secretariat
	02 FEB (THU)	09:00-13:00	Official Shakedown	Tsumagoi village
		15:00	Rally HQs open	Hotel Green Plaza
		15:00	Establish of Official Notice Board	Rally HQs
		15:00-21:00	Administrative Check 1 for JSR Recce and Service Registrations	Rally HQs
		15:00	Service Park open	Service Park
		21:00	Rally HQs close	Rally HQs
	03 FEB (FRI)	06:00	Rally HQs open	Rally HQs
		06:00-07:00	Administrative Check 2 for JSR Recce and Service registrations	Rally HQs
		06:30-15:00	Reconnaissance	
		09:00-12:00	Scrutineering for JSR	Tsumagoi Hall/Gunma Toyota Tsumagoi branch
		13:00-14:00	Team course car / Ice note crew briefing	Rally HQs
		15:30	First Stewards' Meeting	Rally HQs
		16:30-17:00	Media Briefing	Press Romm
		17:00	Publication of Start List for LEG 1	Official Notice Board
		17:00-17:45	Opening ceremony and Team manager meeting	Hotel Green Plaza Restaurant
		18:00	LEG1 Start	Asama winter festival at Green Plaza
		22:45	LEG1 Finish	Hotel Green Plaza
		24:00	Rally HQs close	Rally HQs close
	04 FEB (SAT)	07:00	Rally HQs open	Rally HQs
		07:00	Publication of Start List for LEG 2	Official Notice Board
		09:00	LEG2 Start	Hotel Green Plaza
		16:39	LEG2 Finish	Hotel Green Plaza
		18:30	Prize giving for East Japan Championship and Open Class	Hotel Green Plaza Restaurant
		19:00	Publication of Start List for LEG3	Official Notice Board
		20:00	Rally HQs close	Rally HQs
	05 FEB (SUN)	07:00	Rally HQs open	Rally HQs
		08:00	LEG3 Start	Hotel Green Plaza
		15:36	LEG3 Finish	Hotel Green Plaza
		16:00	Post-Event Scrutineering	Scrutineering, Hotel Green Plaza
		17:30	Publication of Provisional Results	Official Notice Board
		18:00-20:00	Prize Giving	Hotel Green Plaza Restaurant
		21:00	Rally HQs close	Rally HQs

4 Entries

4.1 Dates

Opening Dates for Overseas Competitors: Thursday 24 November 2016, 09:00hrs

for National Competitors: Thursday 08 December 2016, 09:00hrs

Closing Dates for Entries for Overseas Competitors: Friday 23 December 2017, 21:00hrs

for National Competitors: Tuesday 10 January 2017, 21:00 hrs

4.2 Entry Procedure

4.2.1 Permanent Secretariat

Address : 1514-1, Sarugakyoonsen, Minakami, Tonegun, Gunma 379-1403 Japan
 Name : M.O.S.C.O. Rally Secretariat
 Telephone/FAX : +81-(0)277-20-4633 / +81-(0)278-66-1000
 E-Mail : entry@n-mosco.com
 URL : <http://www.n-mosco.com>

4.2.2 Application

Those who wish to take part of the International Rally of Tsumagoi must send the enclosed entry form, duly completed to the rally permanent secretariat by FAX or E-mail prior to the closing dates. (postal is not accepted) jpg.Image data of the crew and competing car (at least 1MB each) must be sent to the rally permanent secretariat by e-mail for the promotional purpose and the official program.

The following entry forms of the originals signed by the drivers / entrant a must be presented at the administrative check at Rally HQs on the 02 FEB(THU) or 03 FEB(FRI) 2017.

- Entry Form
- Vehicle declaration form
- Service registration form
- Accommodation application form
- Team course car/Ice note crew form (if applicable)
- Official shakedown application form (if applicable)
- Crew Profile
- A copy of the vehicle (rally car) registration
- A copy of the certificate of car temporary importation (if applicable)
- A copy of the insurance for the rally

4.3 Number of Entrants Accepted, and Classes

4.3.1 Maximum number of entries

The maximum number of entries is 90 including jointly run national rally.

The Organiser reserves the right to refuse entries in accordance with Article 74 of the International Sporting Code.

The Organiser will notify those whose entries have not been accepted within eight days of its receipt.

In case of the number of received application exceeds maximum number of entries, the Organiser reserves the right to decide which entries among the non-priority drivers will be accepted. The organiser notifies those whose entries have not been accepted immediately after entry closure. Overseas competition license holders must have a written authorisation to compete from ASN or to obtain its stamp on their entry form.

4.3.2 Eligible Cars for Japan Super Rally series

4WD: the ones which comply Chapter 4 of the 2016 FIA Regional Rally Sporting Regulations and Chapter 4 of the FIA Regional Rally Sporting Regulations V4 (APRC) or the ones comply 2017 JSR regulations.

2WD: the ones which comply Chapter 4 of the 2016 FIA Regional Rally Sporting Regulations and Chapter 4 of the FIA Regional Rally Sporting Regulations V4 (APRC) or the ones comply 2017 JSR regulations.

4.4 Entry Fees / Entry Packages

4.4.1 Entry fees

JPY240,000 (with organiser's optional advertising)

JPY350,000 (without organiser's optional advertising)

This entry fee includes two crew IDs, a rental recce car, a hotel room for crew on the night of 03,04 and 05 February 2017 at Hotel Green Plaza Karuizawa (HQs hotel), Prize giving and the following meals.

03 FEB (FRI) Light meal box for dinner will be provided during the drivers' briefing

04 FEB (SAT) Breakfast at the hotel restaurant. Dinner at the HQs hotel restaurant

05 FEB (SUN) Breakfast at the hotel restaurant. Light meal at the prize giving

06 FEB (MON) Breakfast at the hotel restaurant

4.4.2 Recce Registration

Recce registration form must be filled in and must be sent to the rally permanent secretariat with the entry form.

4.4.3 Team Course Car / Ice Note Crew

A team course car/ice note crew per a competing car is authorised under the following conditions.

The registration form must be sent to the rally permanent secretariat with the entry form.

The registration fee for the team course car/ice note crew is JPY30,000.

- Team course car must be 4WD with snow tyres.
- Two passengers at least(up to the capacity)
- The car must be equipped with towing eyes and towing cable /rope must be ready to use.
- Two x snow shovels
- The course cars are allowed to enter the stage only before the first lap of the stages.
- Cut off time for the course car entering into the stages is 60 mins prior to the first car start time.
- Pace notes exchange points will be notified on a communication.

The course car equipment may be checked before entering the stages.

4.4.4 Official Shakedown

A road in Tsumagoi will be provided for the official shakedown from 09:00 to 13:00hrs on 02 FEB (THU) 2017.

The registration form must be sent to the rally permanent secretariat with the entry form.

The registration fee for the official shakedown is JPY20,000.

4.4.5 Service Registration

Service vehicle(s) must be registered with the service registration form and the form must be sent to the rally permanent secretariat with the entry form.

The registration fee for the 1st service vehicle is JPY15,000 including five IDs for service crew.

The registration for the 2nd service vehicle is JPY10,000 including two IDs for service crew.

Service crew ID with no service vehicle is JPY2,000 / person

Note: All those registration fee do not include hotel rooms and meals.

Maximum two service vehicles per a competing car are authorised in the service park. Other team vehicles must be parked in the designated area outside the service park.

A vehicle servicing more than two rally cars must declare the rally permanent secretariat at the time of entry.

The following room rates for Hotel Green Plaza will apply for registered service crew.

The service crew who wish to stay at the Hotel Green Plaza must book the rooms through the rally permanent secretariat in advance.

02 FEB (THU)	with dinner and breakfast	per person	JPY9,500
02 FEB (THU)	with breakfast	per person	JPY7,500
03 FEB (FRI)	with dinner and breakfast	per person	JPY9,500
03 FEB (FRI)	with breakfast	per person	JPY7,500
04 FEB (SAT)	with dinner and breakfast	per person	JPY10,500
04 FEB (SAT)	with breakfast	per person	JPY8,500
05 FEB (SUN)	with Prize giving and breakfast	per person	JPY13,500

4.5 Payment Details

Entry & registration fees must be paid by bank transfer to the following account:

Wire Transfer Instructions

Payment Currency : Japan, Yen (JPY)

Bank Name : Gunma Bank Numata-branch

City, Province or Territory : Numata-ctiy Gunma

Country : Japan

Bank Account Number : 210-1482223

Account Name : Tokuteihieirikatsudouhouzin

M.O.S.C.O.

Swift Number : GUMAJPJT

The amount is payable in Japanese Yen (JPY) only. All transfer expenses / bank fee shall be borne by the competitors. No cheques will be accepted. The entry will only be accepted if accompanied by the total entry fee.

4.6 Refunds

Entry fees will be refunded in full in the following cases :

(1) where an entry is not accepted

(2) where the rally is not held

The Organiser may refund 50% of the entry fee to those competitors who, for reasons of 'force majeure' (duly certified by their ASN), were unable to compete in the event.

5 Insurance

All competing vehicles registered outside Japan must be covered by Japanese compulsory automobile third party liability insurance (Jibaiseiki) and by a third party injury and property insurance policy effective throughout the event. Competing vehicles registered outside Japan and their crews are covered under insurance policies held by the organiser, and its contract details are listed below.

(figures in USD are based on the exchange rate of USD1 = JPY120)

5.1 Special Stages

Special Stage spectator liability insurance:

- 1) Death cover - up to JPY100,000,000 (approx USD833,000)
- 2) Hospitalisation - JPY7,500 per day (approx USD62/day)
(Maximum 180 days from the day of the incident)
- 3) Outpatient treatment - JPY5,000 per day (approx USD41/day)

5.2 liaison

Third party injury and property insurance for competing vehicles on Road Sections:

- 1) Death/Injury cover - unlimited
- 2) Property damage cover - up to JPY5,000,000 (approx USD41,000) (includes cover on Special Stages)
- 3) Passenger cover - up to JPY5,000,000 (approx USD41,000)

The maximum number of days of coverage for hospitalization for passengers is 180 days from the day of the accident. The maximum number of days of outpatient treatment for passengers is 90 days within 180 days from the day of accident.

This insurance arranged by the organiser will be in effect from the start of the rally until the finish of the rally or until a crew's retirement/exclusion from the rally. All team vehicles, even though they may bear plates issued by the organiser, are not considered to be official competitors in the event and are therefore not covered by the organiser's insurance.

5.3 Competing Vehicle registered in Japan

All competing vehicles registered in Japan must be covered by additional third party insurance that policy valid for rally competition, which must be arranged by the competitors themselves or by the rally permanent secretariat. The insurance must cover at least:

Death/Injury cover: more than JPY20,000,000

Property damage cover: JPY2,000,000

Passenger cover: JPY10,000,000

(JMRC Mimaikin can be used for Passenger insurance)

Competitors who wish to arrange the insurance through the rally secretariat must apply at the time of entry.

The application form for the insurance can be downloaded from the rally website.

The following personal accident insurance cover for service crew and team members other than the competing crew may be purchased through the Organiser :

- 1) Death cover - up to JPY100,000,000 (approx USD833,000)
- 2) Hospitalisation – JPY5,000 per day (approx USD41/day)

The maximum number of days of hospitalization and outpatient treatment for passengers is 180 days in total, from the day of the accident.

6 Advertising and Identification

6.1 On Windows

Advertising is permitted on the body of the vehicle including the roof. Advertising on upper part of the front windscreen is prohibited, with the exception of, on overseas-registered vehicles. A strip on the upper part of the front windscreen that may contain advertising of a maximum 10cm (for permitted vehicles), and rear window that may contain advertising within the 8cm height from the top or bottom of the window.

6.2 Optional Advertising

Competitors who accept the Organiser's optional advertising must reserve spaces on their vehicles, as indicated in Appendix 7.

6.3 Alcohol and Tobacco Advertising

There are no restrictions advertising on competing vehicles or team uniforms in Japan, including ones on alcohol or tobacco

6.4 Rally Plates and Competition Numbers

The Organiser will provide the rally plates and competition numbers in accordance with Article 18 of the 2017 FIA Regional Rally Sporting Regulations and those must be affixed as specified in Appendix 7, before it is brought to Scrutineering and must be in place and visible for the duration of the rally. A fine of JPY54,000 will be imposed for any breach of this regulation.

7 Tyres

7.1 Tyres

Road legal tyres including studded or spiked tyres are permitted. Refer to Appendix 10 for the specific regulations for studs.

7.2 Number of tyres

Maximum number of tyres is 20

Tyres for Parc Ferme are not counted.

7.3 Tyre Chain

The use of tyre chains is allowed for 2WD vehicles only by clerk of the course's direction on an official bulletin.

8 Fuel

The permissible lead content of fuel allowed in Japan is 0g/litre based on the JIS K2255 examination procedure. Only re-fuel is allowed at the designated petrol stations on the road books after pre-event scrutineering till the end of the rally.

9 Reconnaissance

9.1 Reconnaissance is held on 03 FEB (FRI) under the organiser's control for the competing crew.

9.2 Recce card and car identification will be issued at Recce registration at 15:00-21:00 on 02 FEB(THU)

9.3 Refer to Appendix 2 for detailed Recce Schedule.

9.4 Specific Restrictions

9.4.1 Only 4WD Recce car provided by the organisers is authorised for Recce.

The pick up procedure of Recce car will be announced on a communication.

9.4.2 Recce identification must be displayed during the Recce.

9.4.3 Crews are authorised to drive a maximum of two times over the route of each special stage.

For reconnaissance purposes, any stage / any part of stage used more than once during the rally is considered a single stage / a single part.

9.5 Traffic Regulations

9.5.1 During reconnaissance, competitors must comply strictly with the road traffic laws and any further requirements of the organiser as published in the Supplementary Regulations or in the bulletins. At all times, the safety and rights of other road users must be respected. Officials may monitor the behaviour of competitors on the reconnaissance route using visual, electronic, photographic or video methods. All offences will be reported to the stewards who may impose penalties that may go as far as refusal to start.

9.5.2 Speed limits as signposted on all roads used during reconnaissance must be observed. Failure to comply will result in a penalty to be applied by the Stewards according to Article 20.2 of the 2017 FIA Regional Rally Sporting Regulations.

9.6 Reconnaissance tyres

Only equipped spare tyre on recce car (or similar) is authorised to replace in case of flat.

10 Administrative Checks

10.1 Documents to be presented

1) Following licenses for the crew.

- Competition license
- Civil driving licenses or international driving permit which allows to drive in Japan.

2) Entrant's competition license

3) Medical certificate

4) Written authorisation from ASN (overseas competition license holders)

5) Competing vehicle's registration, compulsory insurance and additional third party insurance valid for the rally.

6) Overseas-registered competing vehicle's carnet verification certificate issued by JAF.

or Customs Tariff Laws (Kanzen Teiritsu Hoh) import documentation.

Note: Vehicles imported by ATA Carnet may not participate in International Rally of Tsumagoi.

10.2 Administrative checks

Location: Rally HQs at the 2nd floor of Hotel Green Plaza

Date: 15:00 - 21:00hrs on 03 FEB (THU) 2017

06:00 - 07:00hrs on 03 FEB (FRI) 2017

11 Scrutineering Venue and Schedule

11.1 Venue and Schedule

Venue: Tsumagoi Hall / Gunma Toyota Tsumagoi branch

Address: 890 Mihara, Ohaza, Tsumagoi TEL 0279-97-2311

Date: 09:00-14:00 on 03 FEB (FRI)

The marking/sealing of turbochargers (if applicable), gearboxes and differentials will take place at scrutineering in accordance with a schedule on a communication.

11.2 Mud Flaps

Mud flaps which comply with Article 252.7.7 of Appendix J of the FIA International Sporting Code may be fitted to competition cars

11.3 Windows/Nets

The use of silvered or tinted films on the side and rear windows is authorised in accordance with Article 253.11 of Appendix J of the FIA International Sporting Code.

11.4 Crew's Safety Equipment

The crew must wear homologated crash helmets, racing overalls under wears, gloves, shoes, balaclaves and FHRs (such as HANS) in compliance with Appendix L Chapter III of the FIA International Sporting Code. All those clothes and the equipment must be taken to the scrutineering.

11.5 Noise Level

Temporary imported cars must comply with noise level regulations of the country the cars registered. Cars registered in Japan must be compliant with Article 3 of Road Transport Vehicle Act.

11.6 Special National Requirements

The use of Radio is not permitted.

11.7 Specific requirements

Competing car must be equipped with 2 x snow shovel, first aid kit, emergency smoke candle, red signal right, towing rope, tyre chains(2WD only), two reflective triangles and OK/SOS sign in A3

12 Other Procedure

12.1 Drivers Briefing

Entrant and Crew must attend the drivers briefing at 17:00 on 03 FEB(FRI)

12.2 Start of the rally

12.2.1 The rally start by one minute interval at the start arch in front of Hotel Green Plaza at 18:00 on 03 FEB (FRI) . There will be a start ceremony at the start area.

12.2.2 Ten seconds penalty per minute delay will be imposed, if a crew fails to start on time. A crew with more than 30 minutes delay is not authorised to start the rally.

A crew with delay of a minute to 30 minutes to receive the actual start time on its Time Card at the start.

12.2.3 The start list will be issued on the official notice board.

LEG 1 Start list publication at 17:00 on 03 FEB 2017 (FRI)

LEG 2 Start list publication at 07:00 on 04 FEB 2017 (SAT)

LEG 3 Start list publication at 19:00 on 04 FEB 2017 (SAT)

12.2.4 All the crew will run by one minute interval throughout the rally except rally officials' direction.

12.3 Time Control

12.3.1 Official time throughout entire Rally will be Japan Standard Time.

12.3.2 Early check in without incurring penalties is authorised at the TC 5B, TC13B, and TC20B

12.3.3 The competing car in JSR may be driven by authorised representatives of the competitor from the last service of Leg 1 and Leg 2 to the Parc Ferme, respecting all the formalities of time card presentation and related penalties.

12.4 Special Stages

12.4.1 Special Stages will be timed to the tenth of a second.

12.4.2 Start interval is one minute for all the cars.

12.4.3 Special Stage starts will be conducted with electronic countdown system. Refer to Appendix 6 for the start sequences.

12.4.4 SS9 on LEG 2 section 2, SS13 on LEG2 section 3, SS20 on LEG3 section 5 will be conducted as Super Special Stages that run under 2017 FIA Regional Rally Sporting Regulations 41. Refer to Appendix 8 for the details.

12.4.5 In case of a competing vehicle stopping on a Special Stage and considered dangerous by rally officials, the competing car will be removed from the stage.

After removal, If the vehicle is unable to continue, the vehicle is considered retired from the day / rally.

Refer to 12.4.7, If the vehicle continues.

12.4.6 Refer to 12.4.7, If a competing vehicle receives outside assistance in case of stuck on a Special Stage.

12.4.7 In case of removal by rally officials (or by assistance from outside) from Special Stages as 12.4.5 or in case of outside assistance as 12.4.6, the crew will be given the slowest time in the same class + 3 minutes for it's Special Stage time and the crew will receive "removal" identification to the car to continue. The late check in without incurring penalty at the following time control is authorised. However, the crew may be forced to retire from the day / rally, If the delay is considered impossible to catch up the rally schedule.

12.4.8 12.4.7 is applied only once per crew throughout the rally and the crew will be forced to retire after the second removal with an exception of incidents on Super Special Stages conducted to 12.4.4

12.5 Tyre Changing Zone

The organiser may create tyre changing zone(s) depending on the road conditions. Creation of tyre changing zone will be announced on an official bulletin.

12.5.1 Purpose

Tyre changing zone is solely for tyre changing therefore only the following is permitted. Any infringement carried out will be reported to the stewards.

1)Crew and two identified members(mechanics) are permitted to work on their car.

2)Only FOUR tyres, tyre changing tools, a jack and a flat plate for the jack are allowed to carry into the zone.

12.5.2 Tyres to be counted

After creation of tyre changing zone, only tyres used on Special Stages are counted for the maximum number of tyres used. Parc Ferme / Liaison tyres are no longer considered to be counted.

12.5.3 No extra time

Tyre changing zone is a part of liaison and no extra time will be given for tyre changing.

12.6 Rally 2

Re-Start (Rally 2) after retirement from a day

12.6.1 Those crews who wish Rally 2 after retirement from LEG 1 or LEG 2 is authorised to start the following day as Rally 2. The crew who wish Rally 2, must apply Rally 2 application to Clerk of the Course by 23:00 on 03 FEB(FRI) for LEG 2 and 18:00 on 04 FEB(SAT) for LEG 3.

12.6.2 Crew wish Rally 2 on LEG 2 or LEG 3 must present re-scrutineering sheet to the chief scrutineer and must have their vehicle re-scrutineered at least 30 minutes prior to its start time.

12.6.3 Rally 2 crew will not be included in the final results but will be included in the day results.

12.6.4 Special Stage time of Rally 2 crew will be officially published.

12.7 Compensation for a loss

12.7.1 Crew has responsibility for a loss / damage to crew themselves, its vehicle, equipment and any third party properties in case of incident /accident during the rally.Crew must recognise that FIA, JAF, the rally organiser, rally organising committee, Road administrator,Police and Relevant ministries and agencies are exempt from any responsibility.

12.7.2 Any damages to the properties of the organiser, organising committee and Road facilities such as guard rails, mirrors and signs must be compensated by the entrant.

12.8 Prize Giving

All the crews are invited to attend the prize giving.

Date: 18:00 to 20:00 on 05 FEB (SUN) 2017

Venue: Restaurant of Hotel Green Plaza located on the 2nd floor

Dress Code: Smart casual (no T shirts and no sports cloths please)

Extra ticket (Admission fee for crew is included in the entry): JPY6,500 per person (JPY3,000 for child)

13 Identification of Officials

Post chiefs and other marshals will be identifiable by their attire as listed below:

Post Chief Blue tabard with white lettering	Post Chief Blue tabard with white lettering
Post Marshal Orange tabard with white lettering	Post Marshal Orange tabard with white lettering
Special Stage Commander	Green tabard with yellow lettering
Radio Marshal	Yellow tabard with black symbol
Chief Spectator Marshal	Red tabard with yellow lettering
Spectator Safety Marshal	Red tabard with white lettering
Safety Marshal	Red tabard with white lettering
Medical Officer	Green tabard with a white cross
Competitor Relations Officer	Yellow tabard with black lettering
Scrutineer	Black tabard with yellow lettering
Other official	Official IDs

14 Prizes

1st, 2nd and 3rd of the each class: Trophy & extra prizes

4th, 5th and 6th of the each class: extra prizes

The organiser reserves the right to limit the prizes for a small entry in a class after the entry closure.

15 Post Event Scrutineering and Protests

15.1 Post Event Scrutineering

Cars subject to final checks must have a team representative or a crew present.

venue : HOTEL GREEN PLAZA KARUIZAWA Scrutineering Venue

date : 16:00 on 05 FEB(SUN) 2017

15.2 Protest Fees

The cost of the protest to the FIA will be EUR 500.

If a protest requires the dismantling and re-assembly of a clearly defined part of the car the claimant must pay a deposit of JPY 54,000.

For details of protest and appeals, refer to the Article 55 - Protests and Appeals of the 2017 FIA Regional Rally Sporting Regulations.





15.3 Appeal fees

The cost of appealing to the FIA will be EUR 6,000.





16 Interpretation of this Regulations

Any doubt of this regulations and official bulletins, Interpretation of the stewards' meeting is finale.

International Rally of Tsumagoi Organising Committee

		ITINERARY			  		2017/1/6 Ver.1.04	
TC	Location	SS	Liaison	Total	Target	First Car		
SS		Dist.	Dist.	Dist.	Time	Due		
LEG1 Section 1 (Friday 3 February 2017)								
Section 1	TC0	Start (HOTEL GREEN PLAZA KARUIZAWA)					18:00	
		(Distance to next refuel)	(20.129)	(97.316)	(117.445)			
		Ceremonial Start				(0:05)	(18:05)	
	TC1	Nitazawa		13.837	13.837	0:30	18:30	
	SS1	Nitazawa Baragi 1	3.314				18:33	
	TC2	Panorama Reverse		20.269	23.583	0:50	19:23	
	SS2	Panorama R 1	3.882				19:26	
	TC3	Omae		6.465	10.347	0:20	19:46	
	SS3	Omae Suzaka 1	5.737				19:49	
	TC4	Nitazawa		7.765	13.502	0:25	20:14	
	SS4	Nitazawa Baragi 2	3.314				20:17	
	TC5	Panorama Reverse		20.269	23.583	0:50	21:07	
	SS5	Panorama R 2	3.882				21:10	
	TC5A	Service A In		19.669	23.551	0:45	21:55	
		Service A (HOTEL GREEN PLAZA KARUIZAWA)		(0.165)		0:45		
	TC5B	Service A Out & Parc Ferme In					22:40	
	LEG1 Section 1 TOTAL		20.129	88.274	108.403	4:40		
(注) TC5Bは早着ペナルティーを与えない。NOTE: Early check in is allowed without incurring penalties at TC5B								
LEG2 Section 2 (Saturday 4 February 2017)								
Section 2	TC5C	Parc Ferme Out & Service B In					9:00	
		Service B (HOTEL GREEN PLAZA KARUIZAWA)		(0.243)		0:15		
	TC5D	Service B Out					9:15	
		Refuel 1(Ozasa IDEMITSU・ENEOS)		9.042		(0:31)	(9:46)	
		(Distance to next refuel)	(14.812)	(58.359)	(73.171)			
	TC6	Panorama L		8.438	17.480	0:50	10:05	
	SS6	Panorama L 1	6.288				10:08	
	TC7	Imai		3.146	9.434	0:15	10:23	
	SS7	Ishizu kadokai 1	2.296				10:26	
	TC8	Omae		17.350	19.646	0:40	11:06	
	SS8	Omae Suzaka 2	5.737				11:09	
	TC9	Palcall		1.035	6.772	0:10	11:19	
	SS9	Palcall SuperSpecial	0.491				11:22	
	TC9A	Service C In		19.558	20.049	0:40	12:02	
		Service C (HOTEL GREEN PLAZA KARUIZAWA)		(0.165)		0:30		
	TC9B	Service C Out & Regroup In					12:32	
	LEG2 Section 2 TOTAL		14.812	58.569	73.381	3:32		
LEG2 Section 3								
Section 3		Green plaza Regroup				0:45		
	TC9C	Green plaza Regroup Out		(0.045)	(0.045)		13:17	
		Snow Festival Start Ceremonial				(0:05)	(13:22)	
		Refuel 2(Ozasa IDEMITSU・ENEOS)		8.832		(0:35)	(13:52)	
		(Distance to next refuel)	(14.777)	(52.302)	(67.079)			
	TC10	Omae		7.282	16.114	0:50	14:07	
	SS10	Omae Suzaka 3	5.737				14:10	
	TC11	Panorama L		12.139	17.876	0:35	14:45	
	SS11	Panorama L 2	6.288				14:48	
	TC12	Imai		3.146	9.434	0:15	15:03	
	SS12	Ishizu Kadokai 2	2.296				15:06	
	TC13	Prince Land		15.003	17.299	0:35	15:41	
	SS13	Prince Land SuperSpecial 1	0.456				15:44	
	TC13A	Service D In		0.264	0.720	0:10	15:54	
		Service D (HOTEL GREEN PLAZA KARUIZAWA)		(0.165)		0:45		
	TC13B	Service D Out & Parc Ferme In					16:39	
	LEG2 Section 3 TOTAL		14.777	46.666	61.443	4:07		
LEG2 TOTAL		29.589	105.235	134.824	7:39			

(注) TC13Bは早着ペナルティーを与えない。NOTE: Early check in is allowed without incurring penalties at TC13

		  				
		2017/1/6 Ver.1.04				
ITINERARY						
LEG3 Section 4 (Sunday 5 February 2017)						
Section 4	TC13C	Parc Ferme Out & Service E In				8:00
		Service E (HOTEL GREEN PLAZA KARUIZAWA)	(0.243)		0:15	
	TC13D	Service E Out				8:15
		Refuel 3(Tashiro SHELL)	14.468		(0:41)	(8:56)
		(Distance to next refuel)	(23.813)	(76.733)	(100.546)	
	TC14	Tashiro	1.516	15.984	0:45	9:00
	SS14	Aisainooka 1	7.355			9:03
	TC15	Ishizu	17.276	24.631	0:45	9:48
	SS15	Kadokai Panorama 1	4.984			9:51
	TC16	Omae	6.465	11.449	0:20	10:11
	SS16	Omae Suzaka 4	5.737			10:14
	TC16A	Service F In	18.977	24.714	0:50	11:04
		Service F (HOTEL GREEN PLAZA KARUIZAWA)	(0.165)		0:30	
	TC16B	Service F Out & Regroup In				11:34
LEG3 Section 4 TOTAL		18.076	58.702	76.778	3:34	
LEG3 Section 5						
Section 5		Green plaza Regroup			0:20	
	TC16C	Regroup Out				11:54
	TC17	Omae	15.825	15.825	0:30	12:24
	SS17	Omae Suzaka 5	5.737			12:27
		Refuel 4(Tashiro SHELL)	16.674	(22.411)	(0:56)	(13:23)
		(Distance to Finish)	(12.795)	(39.718)	(52.513)	
	TC18	Tashiro	1.516	23.927	1:00	13:27
	SS18	Aisainooka 2	7.355			13:30
	TC19	Ishizu	17.276	24.631	0:45	14:15
	SS19	Kadokai Panorama 2	4.984			14:18
	TC20	Prince Land	19.119	24.103	0:45	15:03
	SS20	Prince Land SuperSpecial 2	0.456			15:06
	TC20A	Prince Land Assemble Zone In	0.706	1.162	0:10	15:16
		Ceremonial Finish (HOTEL GREEN PLAZA KARUIZAWA)				
	TC20B	Parc Ferme In	1.101	1.101	0:20	15:36
LEG3 Section 5 TOTAL		18.532	72.217	90.749	4:02	
LEG3 TOTAL		36.608	130.919	167.527	7:36	
Rally Totals		86.326	324.428	410.754	19:55	

(注)TC20Bはペナルティーを与えない。NOTE: No penalty is applied on early/late check in at TC20B.

TOTALS OF THE RALLY				
	SS	Lialson	Total	%
LEG1(DAY1) 5SS	20.129	88.274	108.403	19%
LEG2(DAY2) 8SS	29.589	105.235	134.824	22%
LEG3(DAY3) 7SS	36.608	130.919	167.527	22%
Total 20SS	86.326	324.428	410.754	21%

Appendix 2

Recce Schedule

Recce route and a schedule within road book.

Appendix 3

Commpetitors Relation Officer (CRO)



Mr.Naoto MARUYAMA
TEL +81 90 7723 6570



Mr.Shunsaku KODERA
TEL +81 90 6921 9881

HOTEL GREEN PLAZA KARUIZAWA LAYOUT

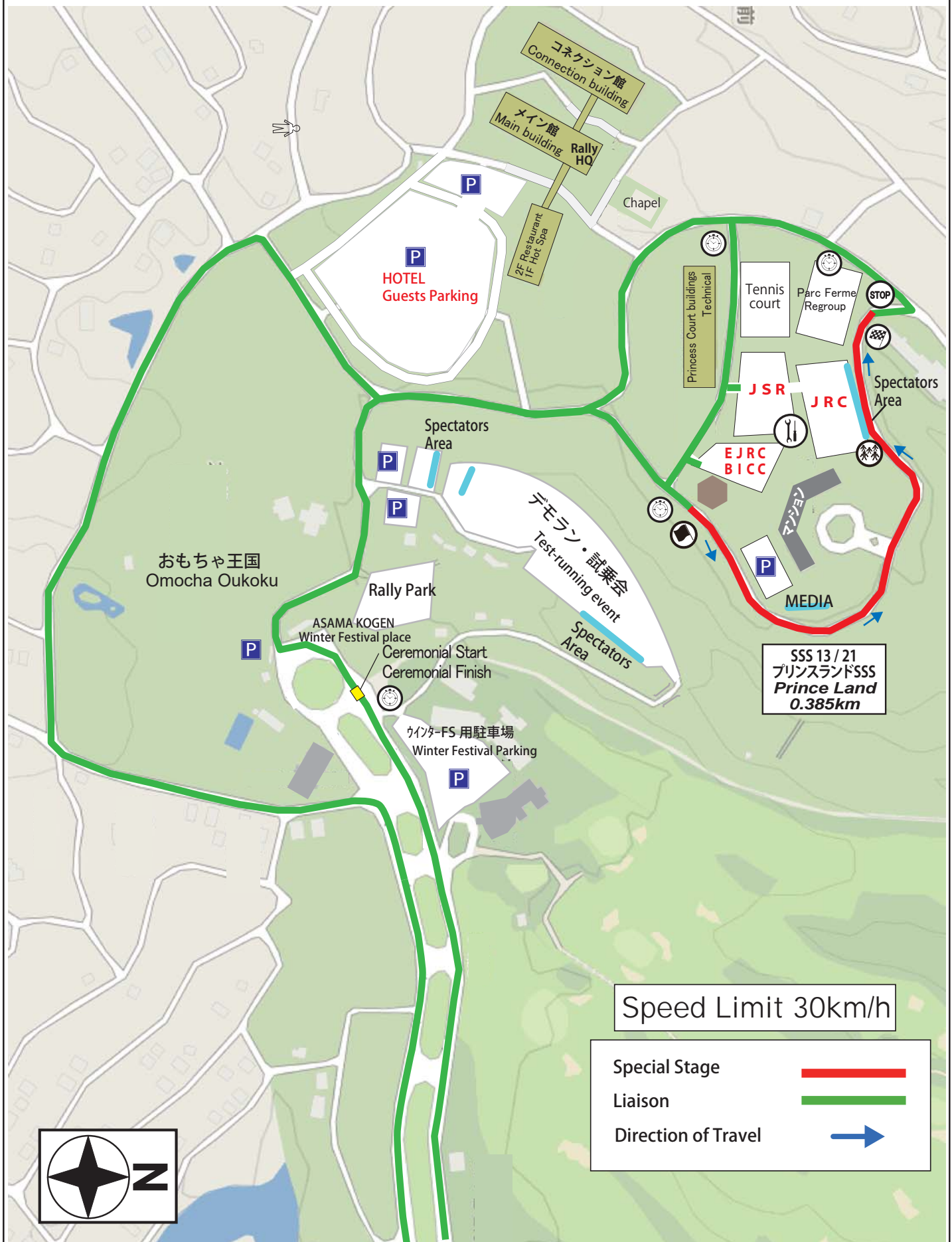

Appendix 5.1

HQs Layout

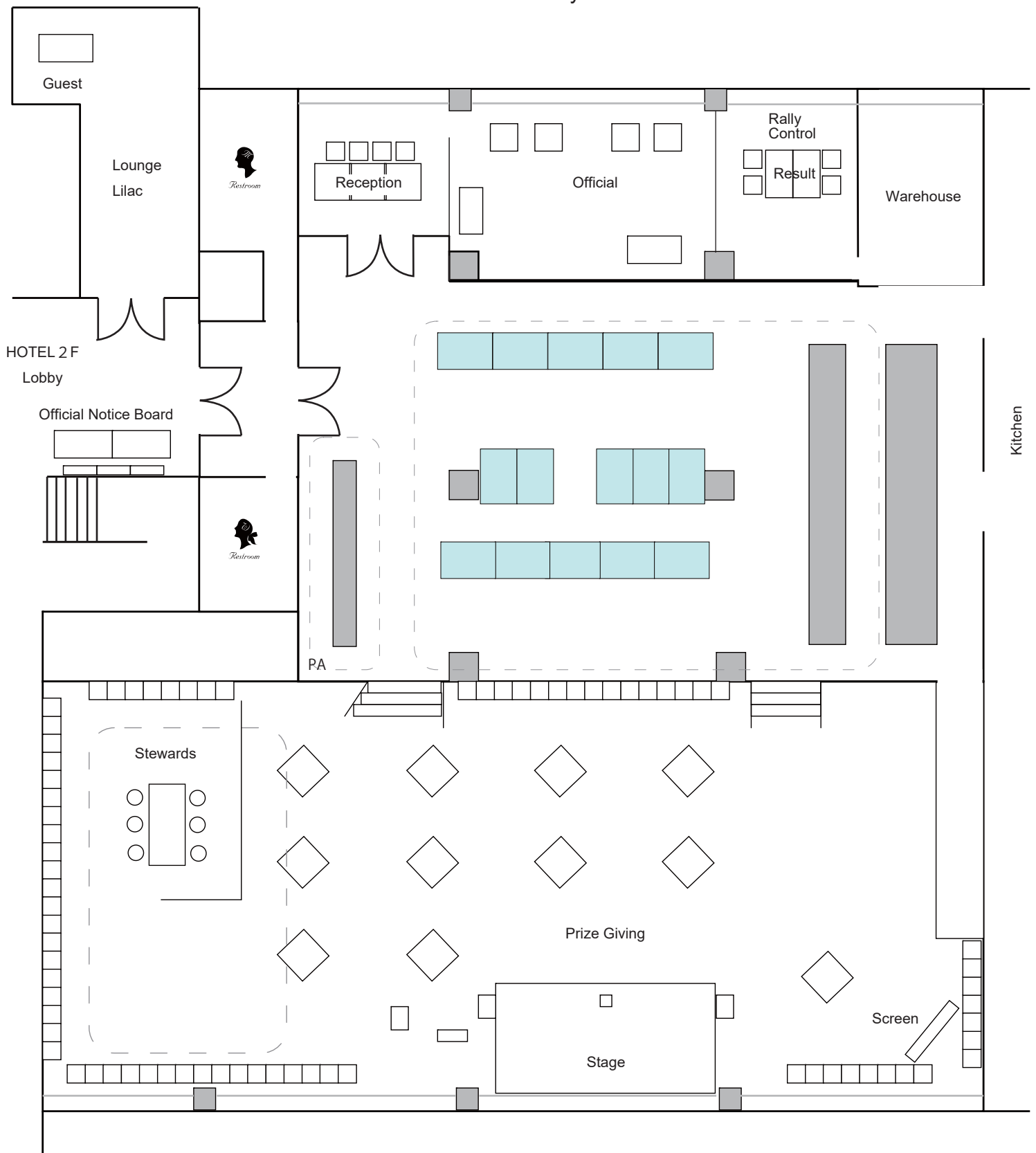

Appendix 5.2
Satellite HQ Layout
Princess Court building 1F



Service park

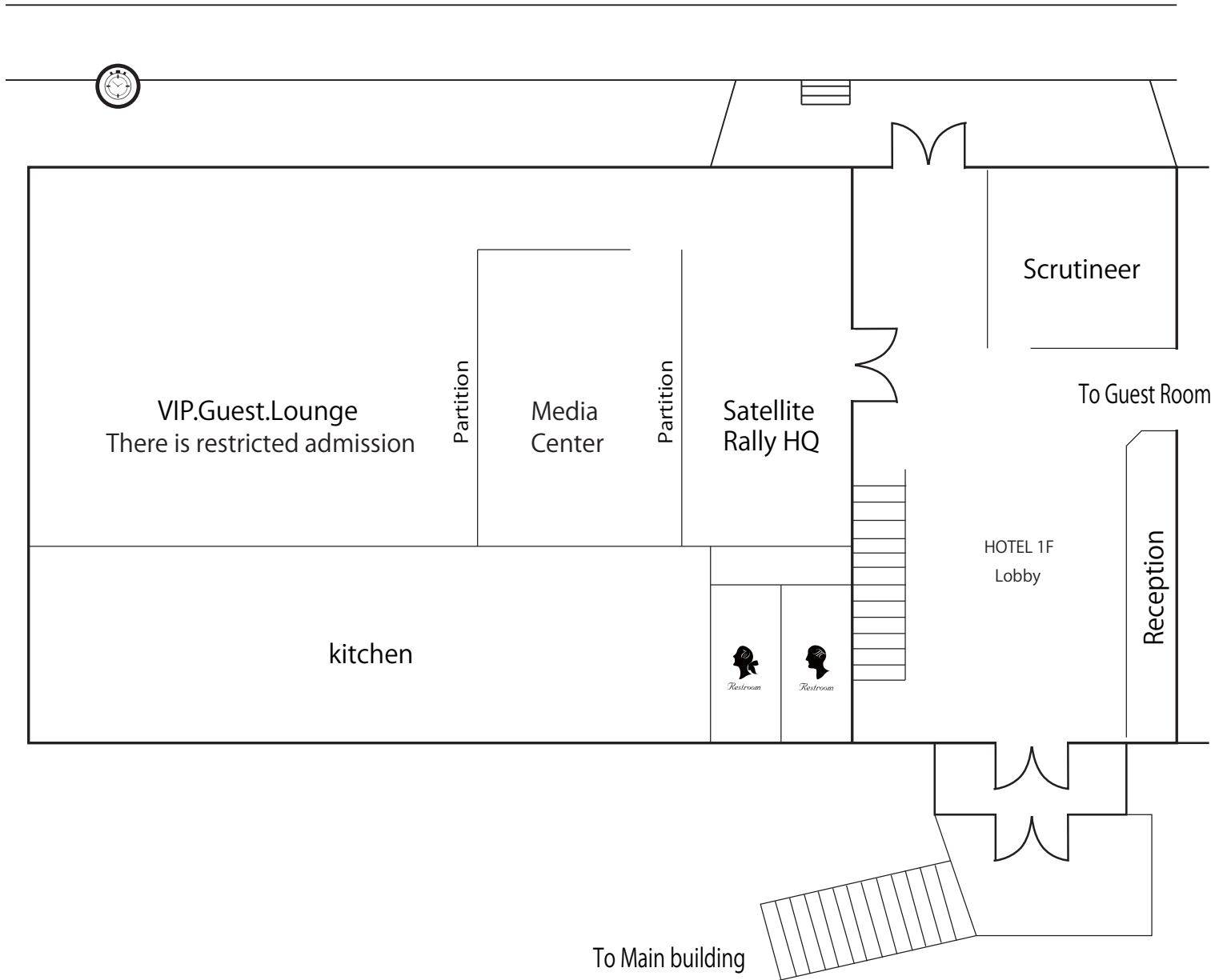

Appendix 6
Start Sequence

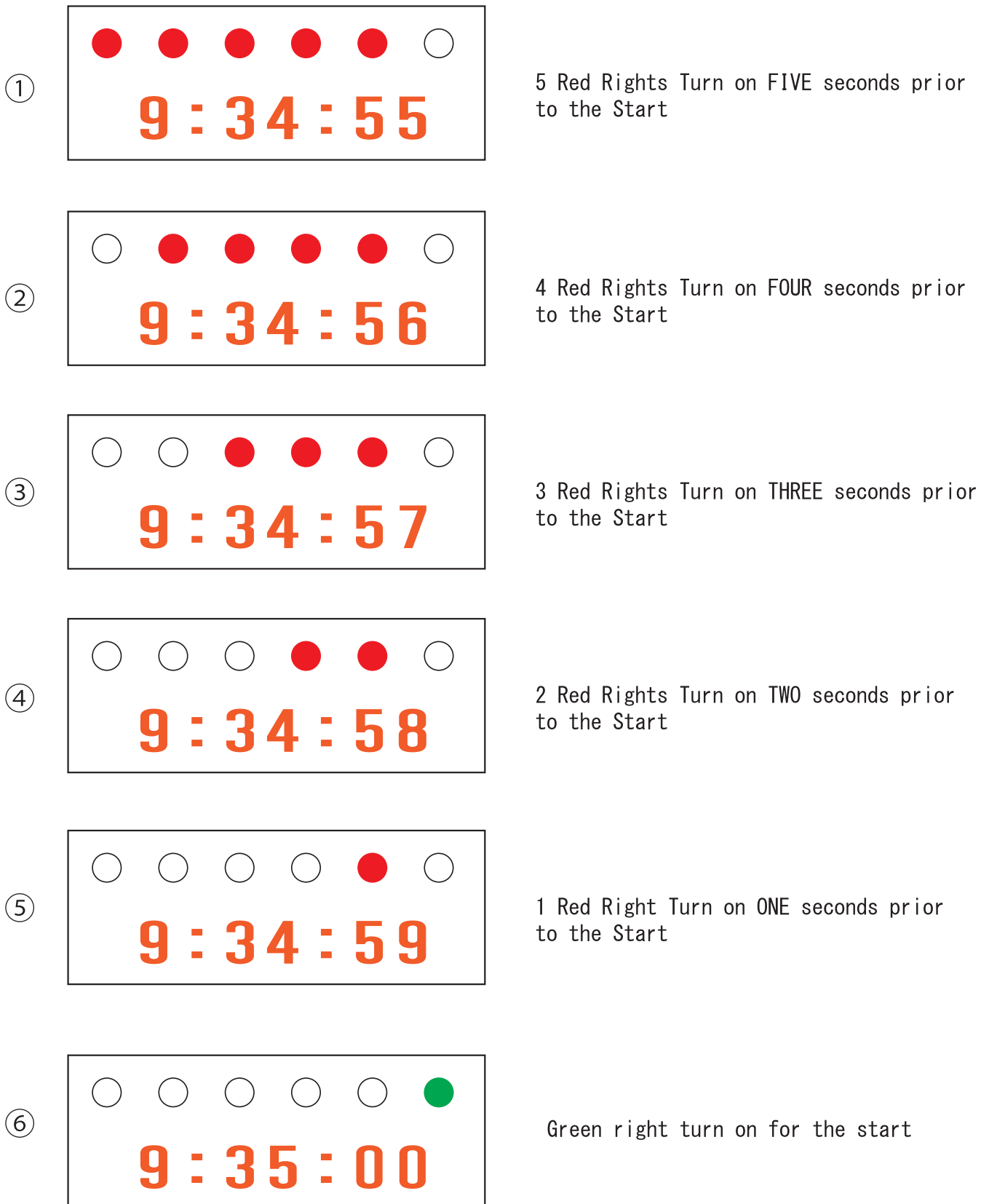

- Jump Strat
the Right FLASHING in case of Jum Start.
- The start will be carried out manually in case of the system down.
The Start Marshals will call 15, 10, 5, 4, 3, 2, 1, 0(GO)

Appendix 7

Competition numbers, Advertising and Driver's names

7.1 Competition numbers, Advertising and Driver's and Co-Driver's names shall be complied with Articles 18 and 19 of the 2017 FIA Regional Rally Sporting Regulations.

7.2 A roof plate will not be supplied for the International Rally of Tsumagoi.

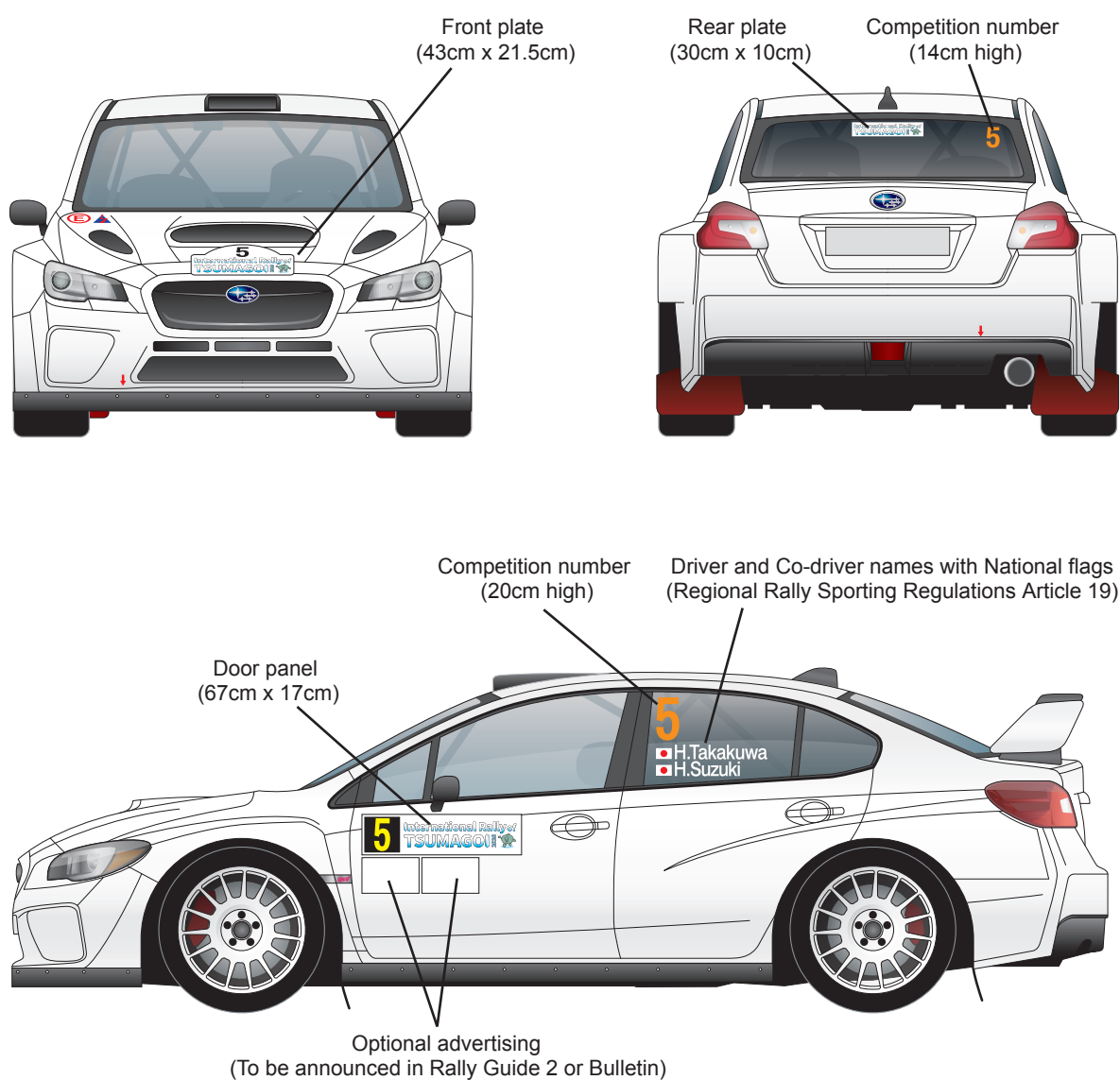

Appendix 8

Super Special Stage

The following are detailed regulations to 25.4

- 25.4.1 SS9 (Palcall), SS13,20 (Prince Land) are Super Special Stages and are held under Supplementary regulations article 25.4
- 25.4.2 In case of a competing vehicle stopping on a Super Special Stage will be removed from the stage and will be placed after the stop control of the stage by rally officials for safety reasons.
- 25.4.3 If a competing vehicle is placed after a stop control as 25.4.2 and continue, the crew will be given three minutes for their stage time.
The late check in without incurring penalty at the following time control is authorised.
- 25.4.4 A competing vehicle starts Super Special Stage after the competing car in front clear the stage .

Appendix 9

Flexi Service

No Flexi Service on the rally.

Appendix 10
Details og Studded tyres authorised

7.1.1 The use of studded tyres

The following studded tyres are authorised to use during the event.

The number of studs must not exceed 12 per any decimeter of the wheel circumference.

7.1.2 Studs

- 1) Studs shall be cylindrical single point.
- 2) The studs must be mounted into the tyre from the outside.
- 3) Studs mounted through the tread is not permitted.
- 4) Stud protrusion beyond the surface of the brand-new tyre is maximum 2 mm.
- 5) Total stud height including point is 15 mm with tolerance of maximum 0,5 mm.

